

CORDLESS 2

Lighter, Brighter, Nicer

English

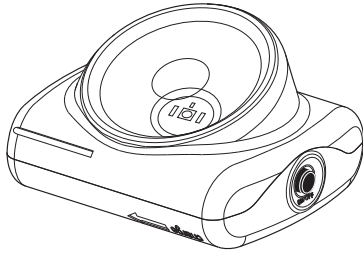

1. Packing list



2. Parts for options

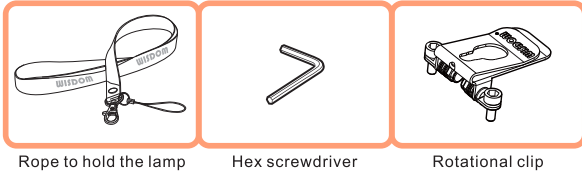

3. General guide

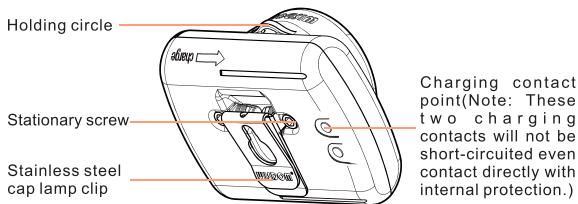
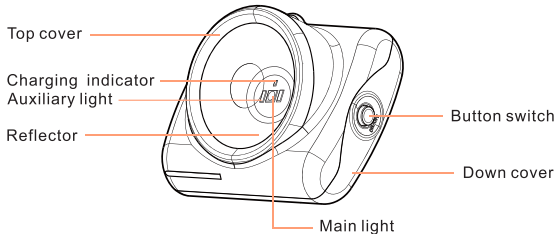

4. Basic parameters

Model	Cordless 2A	Cordless 2B	Cordless 2C	Cordless 2D
Continually working time	≥13h	≥13h	≥13h	≥7h
Charging time(by NWB-30)	5h	5h	5h	4h
weight	175g	175g	128g	128g

5. On and off instruction

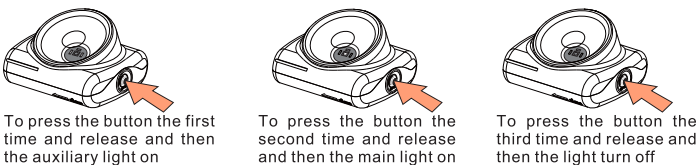

6. Usage guide for the NWB-30 portable charger

(6.1) To put the portable charger plugged with power, then the portable charger indicator lights.

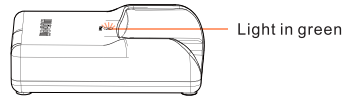

(6.2) Put the lamp as below picture, the charging indicator in the lamp turns red.

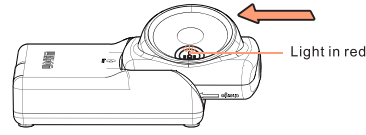

Cordless 2 miner's cap lamp has charging status indicator. The charging indicator light is red means the lamp is charging; the charging indicator is green, means the battery is fully charged. During the charging process, the main light source and two auxiliary light sources emits a low light as the charging process status instructions. When fully charged, the charger indicator turn green from red, the main light and auxiliary light turn off.

(6.3) You can use the lamp either in the process of charging or fully charged the lamp.



(6.4) Turn off the power of the portable charger, then the charger stop working.

7. Battery capacity indication

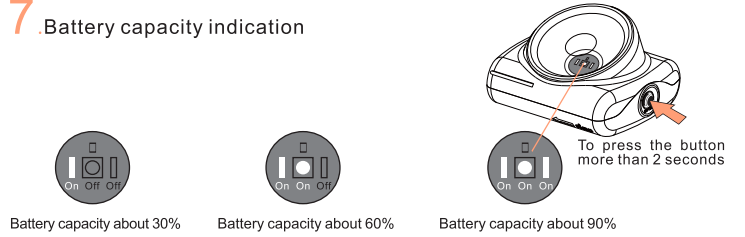

Two-stage low battery alarms and alarm cancel
Approximately one hour before the battery runs out, the main light source will alternately alarms with dark lights (0.5 seconds) every 5 seconds regularly. To warn the user that the battery is nearly exhausted, need recharged. If you do not want the lights flashing affect the lighting, you can press the switch button for more than 2 seconds, the main light source will blink twice to stop the alarm and enter the normal lighting condition.
Sufficient to maintain the battery is only about 10 minutes of lighting, the main light source of the miner's cap lamp rapid alternating light and dark alarm (dark lights 0.5 seconds every 2 seconds), suggesting that the battery is about to run out, you need to immediately charge or switch to the auxiliary light source for more time usage.

8. Note

- (1) NEW WISDOM Cordless2 will be half charged before delivery, please fully charge it before using.
- (2) Please use our own matched chargers to charge our lamps; otherwise the cap lamp will be damaged.
- (3) In order to get the best performance of the cap lamp, please clean the head lamp glass timely.
- (4) If the lamps will be stored for a long period, please repeat the following maintenance steps every two months: full charged→completely discharged→charged for 2hours.

9. Troubles and troubleshooting

Troubles and Troubleshooting	Trouble analysis	Troubleshooting
Light is not on when pressing the button	Battery power is used up	Charge the lamp
Discharging time is less than 13 hours	Battery is not fully charged	Making sure the lamp well connected to the charger when charging

10. Safety warnings

- (1) Shooting at eyes directly must be avoided while the lamp is working since the light is so bright and can hurt eyes.
- (2) Disassembling the cap lamp into parts is not permitted, since it's not safe and reliable to work underground without the full suite/ complete components.
- (3) Forbidden to crash and strike the lamp.
- (4) Not allowed to charge the lamp underground.
- (5) Keep the lamp away from fire sources.
- (6) Do not disassemble the lamp or change the part underground. All the maintenance and repair must be done on the surface! It is not allowed to replace the structure of the cap lamp and the parts.
- (7) Do not disassemble the lamp or repair the battery parts by yourself.
- (8) The discarded cap lamp should be disposed together rather than throw away without management.